

THE INFORMATION CONTAINED IN THIS DOCUMENT IS PROPRIETARY TO Y-S ELECTRONIC, ANY REPRODUCTION IN PART OR WHOLE WITHOUT PRIOR WRITTEN APPROVAL OR AUTHORIZATION OF Y-S ELECTRONIC IS STRICTLY PROHIBITED.

RoHS COMPLIANT

REV.	DESCRIPTION	ECN NO.	DWN.	CHK.	APVD.	DATE
A			Xie		Zhou	2023-06-25

NOTES:

SPECIFICATION:

- 1.CURRENT RATING: 3.0A MAX
- 2.VOLTAGE: 100 VAC
- 3.TEMPERATURE RANGE: -30°C~+85°C
- 4.CONTACT RESISTANCE: 40 MILLION HM MAX
- 5.INSULATION RESISTANCE: 100 MEG OHMS MIN
- 6.INSERTION FORCE: 5N~20N
- 7.UNMATING FORCE: 8N~20N
- 8.DURABILITY: 10000 CYCLES
- 9.WATER PROOFNESS:THIS PRODUCT IS BASED ON IPX8.

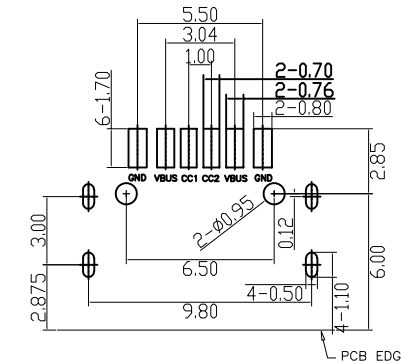
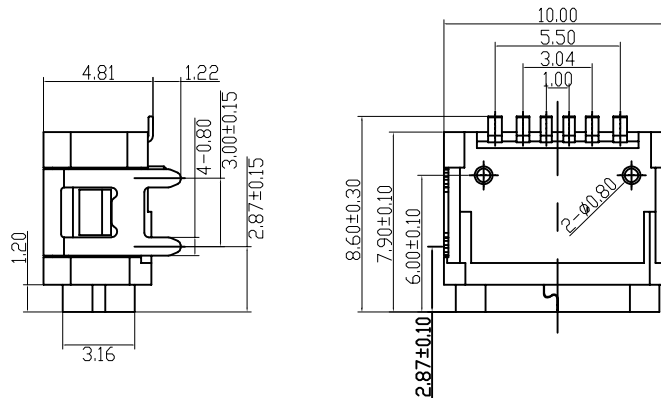
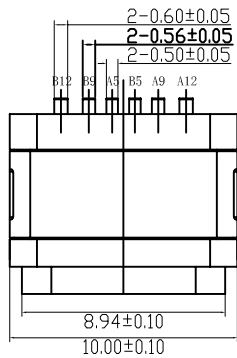
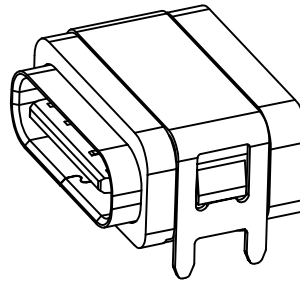
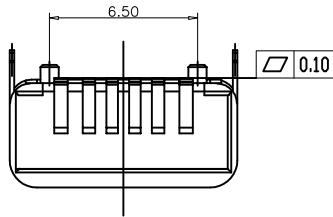

Ordering Information

184j - $\begin{matrix} \text{XX} & \text{X} & \text{X} & \text{X} & \text{X} & \text{X} \\ \text{a} & \text{b} & \text{c} & \text{d} & \text{e} & \text{f} \end{matrix}$

- a. No. Of Pins
06: 06 positions
- b. Contact Type
p: Female IPX7 (SHELL 0.4R)
- c. Contact Plating
0: Gold flash selective gold
- d. Shell Type
1: Nickel
- e. Insulator Color
1: Black (LCP)
- f. Contact Type (Signal Pin)
N: SMD Type

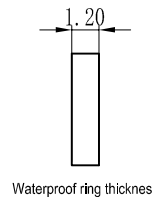
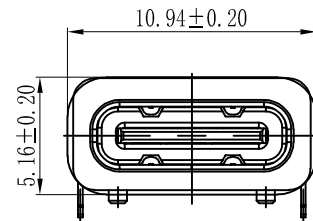
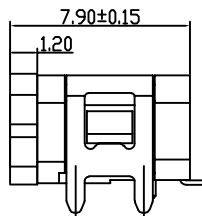
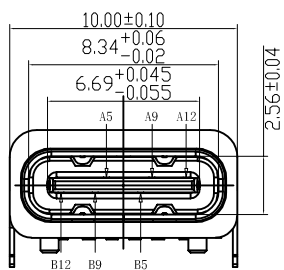

Diagram of adding waterproof ring

RECOMMEND P.C.B LAYOUT (COMPONENT SIDE)
TOLERANCE FOR PCB LAYOUT IS ±0.05

USB TYPE-C PIN ASSIGNMENTS

PIN NUMBER	A1	A2	A3	A4	A5	A6	A7	A8	A9	A10	A11	A12
SIGNAL NAME					CC1				Vbus			GND
PIN NUMBER	B12	B11	B10	B9	B8	B7	B6	B5	B4	B3	B2	B1
SIGNAL NAME	GND			Vbus				CC2				

DIMENSIONS: <input type="checkbox"/> mm [INCH] <input type="checkbox"/> INCH [mm] <input checked="" type="checkbox"/> mm ONLY	CAD GENERATED DRAWING, DO NOT MANUALLY UPDATE DRAWN BY AND DATE Xie 2017-12-15	
	UNLESS OTHERWISE SPECIFIED, GENERAL TOLERANCE: DECIMALS ANGLES X. ±0.38 X* ±3° .X ±0.25 .X* ±1.0° .XX ±0.15	
MATERIAL: 	FINISH: SCALE: 1:1 SIZE: A3	DRAWING NO. 184J-06P011N REV A
FILE NO.:		SHEET 1 OF 1

DO NOT SCALE DRAWING