

THE INFORMATION CONTAINED IN THIS DOCUMENT IS PROPRIETARY TO Y-S ELECTRONIC. ANY REPRODUCTION IN PART OR WHOLE WITHOUT PRIOR WRITTEN APPROVAL OR AUTHORIZATION OF Y-S ELECTRONIC IS STRICTLY PROHIBITED.

RoHS COMPLIANT

REVISIONS				
REV	ECN NO.	DESCRIPTION	APPROVED BY	DATE

Product Specification

Material

Insulator :Glass-Filled Thermoplastic PBT,UL94V-0 rates
 Contact :Brass or Phosphor Bronze
 Shell : Steel, 100u" Tin Over 50u" min Copper
 Clinch Nut: Brass, 100u" min Nickel Plated.
 Boardlock :Brass, 100u" min Tin Plated.

Electrical

Contact Resistance :30 milliohms
 Max at 1 AMP DC.
 Insulation Resistance :1000
 megohms at 500 VDC
 Dielectric Withstanding Voltage :
 1000 VAC/rms 60Hz for 1 minute
 Current Rating :3 AMP
 Voltage Rating :250 VAC/rms 60Hz

Ordering Information

167 - $\frac{XX}{a} \frac{X}{b} \frac{X}{c} \frac{X}{d} \frac{X}{e} \frac{X}{f} \frac{X}{g}$

- a. No. Of Pins
 09: 09 positions
 25: 25 positions
- b. Contact Type
 1: Male
 2: Female
- c. Contact Plating
 0: gold flash selective gold
 1: 15u" selective gold on contact
 2: 30u" selective gold on contact
- d. Shell Plating
 1: Nickel(standard)
 2: Tin
 3: Chromated
- e. Insulator Color
 1: Blue
 2: Black (Standard)
- f. Rivetting Options:
 0: None
 1: Snap-in boardlock
 2: Press-in boardlock
- g. Flange Mounting Option
 0: $\varnothing 3.05$ mm clear hole
 1: #4-40 threaded hole with #4-40 unc screwlock installed
 2: #4-40 threaded hole with #4-40 unc screwlock bulk-packed
 3: #4-40 threaded hole

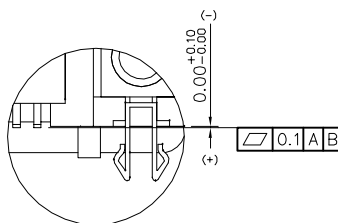
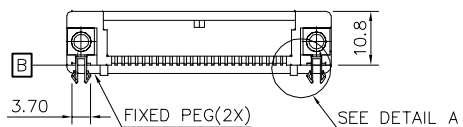
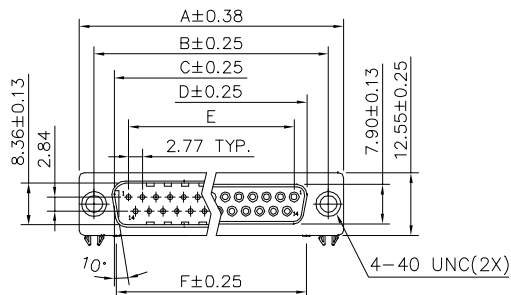

DETAIL A
 SCALE 3:1
 Snap-in boardlock

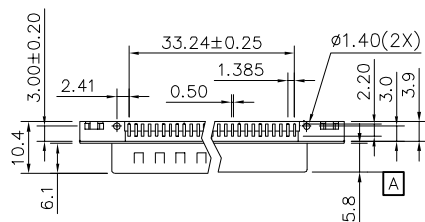

Dimensions

Positions	A	B	C	D	E	F
9	30.81	24.99	16.92	16.33	11.08	15.90
25	53.05	47.04	38.96	38.38	33.24	38.06

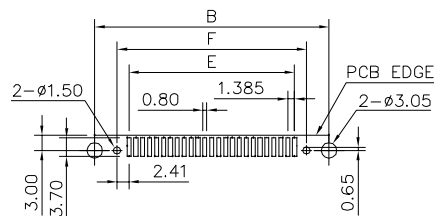

MALE PIN NUMBER:
 5 9 4 8 3 7 2 6 1

FEMALE PIN NUMBER :
 1 6 2 7 3 8 4 9 5

9 PIN RECOMMENDED PCB LAYOUT

MALE PIN NUMBER:
 13 25 12 24 11 23 10 22 9 21 8 20 7 19 6 18 5 17 4 16 3 15 2 14 1

FEMALE PIN NUMBER:
 1 14 2 15 3 16 4 17 5 18 6 19 7 20 8 21 9 22 10 23 11 24 12 25 13

25 PIN RECOMMENDED PCB LAYOUT

DO NOT SCALE DRAWING

DIMENSIONS: <input type="checkbox"/> MM [INCH] <input type="checkbox"/> INCH [mm] <input checked="" type="checkbox"/> MM ONLY	CAD GENERATED DRAWING, DO NOT MANUALLY UPDATE DRAWN BY AND DATE JACK HONG 24-04-08	Y-S ELECTRONIC CO., LTD. No. 101, Sec. 1, Long-An Street, Lu-Chu, Taoyuan, Taiwan, R.O.C. TEL: +886-3-3609819 FAX: +886-3-3609817	
	UNLESS OTHERWISE SPECIFIED, GENERAL TOLERANCE: DECIMALS ANGLES X: ±0.38 [0.015] X*: ±3° .X ±0.25 [0.010] .X*: ±1.0° .XX ±0.13 [0.005]		CHECKED BY AND DATE JUSTIN XING 24-04-08 APPROVED BY AND DATE MICHAEL HUANG 24-04-08 THIRD ANGLE PROJECTION
MATERIAL FINISH	SCALE: 1 : 1 SIZE: A3	DRAWING NO. 167-XXXXXX1X FILE NO.:	REV A SHEET 1 OF 1

THE INFORMATION CONTAINED IN THIS DOCUMENT IS PROPRIETARY TO Y-S ELECTRONIC. ANY REPRODUCTION IN PART OR WHOLE WITHOUT PRIOR WRITTEN APPROVAL OR AUTHORIZATION OF Y-S ELECTRONIC IS STRICTLY PROHIBITED.

RoHS COMPLIANT

REVISIONS				
REV	ECN NO.	DESCRIPTION	APPROVED BY	DATE

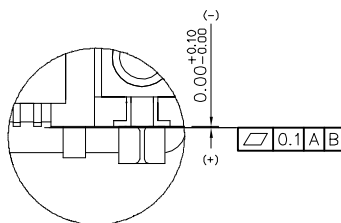
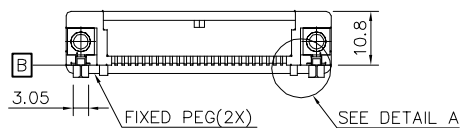
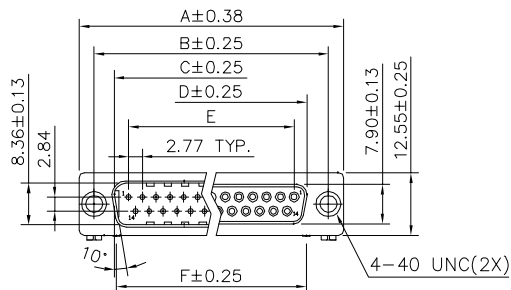

DETAIL A
SCALE 3:1
Press-in boardlock

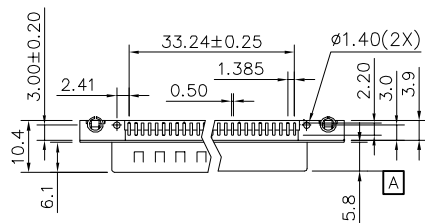

Dimensions

Positions	A	B	C	D	E	F
9	30.81	24.99	16.92	16.33	11.08	15.90
25	53.05	47.04	38.96	38.38	33.24	38.06

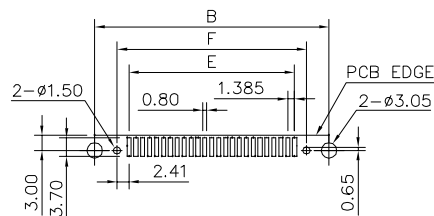

MALE PIN NUMBER:
5 9 4 8 3 7 2 6 1

FEMALE PIN NUMBER :
1 6 2 7 3 8 4 9 5

9 PIN RECOMMENDED PCB LAYOUT

MALE PIN NUMBER:
13 25 12 24 11 23 10 22 9 21 8 20 7 19 6 18 5 17 4 16 3 15 2 14 1

FEMALE PIN NUMBER:
1 14 2 15 3 16 4 17 5 18 6 19 7 20 8 21 9 22 10 23 11 24 12 25 13

25 PIN RECOMMENDED PCB LAYOUT

Product Specification

Material

Insulator :Glass-Filled Thermoplastic PBT,UL94V-0 rates
Contact :Brass or Phosphor Bronze
Shell : Steel, 100u" Tin Over 50u" min Copper
Cinch Nut: Brass, 100u" min Nickel Plated.
Boardlock :Brass, 100u" min Tin Plated.

Electrical

Contact Resistance :30 milliohms
Max at 1 AMP DC.
Insulation Resistance :1000
megohms at 500 VDC
Dielectric Withstanding Voltage :
1000 VAC/rms 60Hz for 1 minute
Current Rating :3 AMP
Voltage Rating :250 VAC/rms 60Hz

Ordering Information

167 - $\frac{XX}{a} \frac{X}{b} \frac{X}{c} \frac{X}{d} \frac{X}{e} \frac{X}{f} \frac{X}{g}$

- a. No. Of Pins
09: 09 positions
25: 25 positions
- b. Contact Type
1: Male
2: Female
- c. Contact Plating
0: gold flash selective gold
1: 15u" selective gold on contact
2: 30u" selective gold on contact
- d. Shell Plating
1: Nickel(standard)
2: Tin
3: Chromated
- e. Insulator Color
1: Blue
2: Black (Standard)
- f. Rivetting Options:
0: None
1: Snap-in boardlock
2: Press-in boardlock
- g. Flange Mounting Option
0: #3.05mm clear hole
1: #4-40 threaded hole with #4-40 unc screwlock installed
2: #4-40 threaded hole with #4-40 unc screwlock bulk-packed
3: #4-40 threaded hole

DO NOT SCALE DRAWING

DIMENSIONS: <input type="checkbox"/> MM [INCH] <input type="checkbox"/> INCH [mm] <input checked="" type="checkbox"/> MM ONLY	CAD GENERATED DRAWING, DO NOT MANUALLY UPDATE DRAWN BY AND DATE JACK HONG 24-04-08	 Y-S ELECTRONIC CO., LTD. No. 101, Sec. 1, Long-An Street, Lu-Chu, Taoyuan, Taiwan, R.O.C. TEL: +886-3-3609819 FAX: +886-3-3609817
MATERIAL FINISH	SCALE: 1 : 1 SIZE: A3	DRAWING NO. 167-XXXXXX2X REV A
FILE NO.:		SHEET 1 OF 1